

CONFIDENTIAL: THIS DRAWING CONTAINS A PROPRIETARY DESIGN ORIGINATED BY YASKAWA AMERICA INC. (MOTOMAN ROBOTICS DIVISION YASKAWA MOTOMAN). NEITHER IT NOR THE INFORMATION APPEARING HEREON SHALL BE DISCLOSED, USED, OR DUPLICATED FOR ANY PURPOSE UNLESS SPECIFICALLY AUTHORIZED BY MOTOMAN ROBOTICS. THIS DRAWING IS THE PROPERTY OF MOTOMAN ROBOTICS AND SHALL BE RETURNED TO IT UPON REQUEST. ALL PATENT RIGHTS RELATING HERETO ARE SPECIFICALLY RESERVED.

- NOTES:
- TAG WITH PART NUMBER 196760-2, AND DRAWING REVISION PER DESIGN STANDARD SSGW-077 PARA. 2.3.
 - BECAUSE YASKAWA AMERICA INC. IS CONSTANTLY IMPROVING PRODUCTS, YASKAWA RESERVES THE RIGHT TO CHANGE DESIGN AND/OR SPECIFICATIONS WITHOUT NOTICE.
 - TORQUE VALUES ARE TO BE PER DRAFTING STANDARD SSGW-020, APPENDIX B, UNLESS OTHERWISE SPECIFIED.
 - ALL DIMENSIONS ARE REFERENCE ONLY.
 - UNFINISHED STEEL SURFACES TO BE COATED WITH RUST INHIBITOR PER DESIGN STANDARD SSGW-077 PARA. 3.3.2
 - FOR WIRING DIAGRAM SEE DRAWING 196916-2.

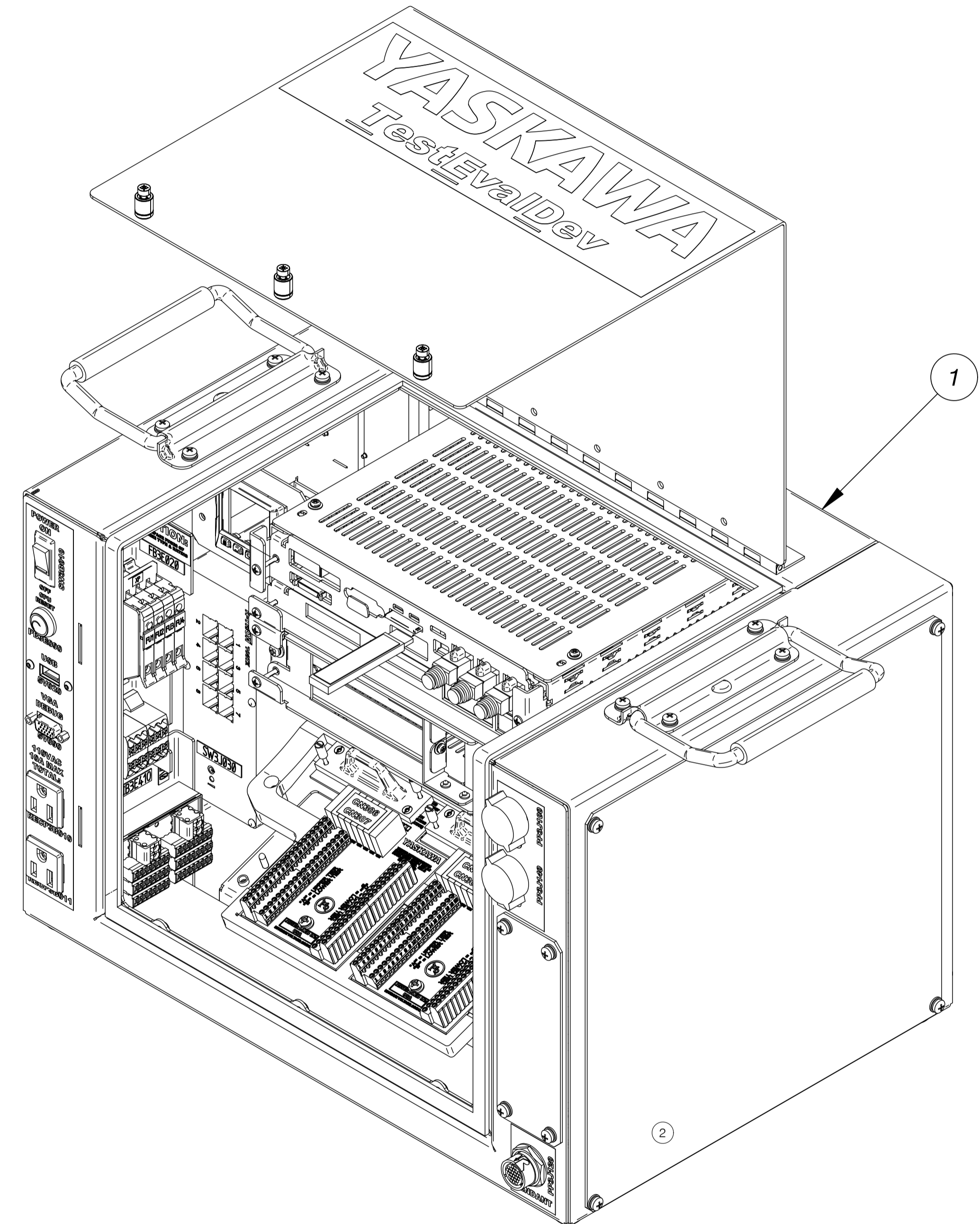

ISOMETRIC VIEW
(REFERENCE ONLY)

ITEM	QTY	P/N	DESCRIPTION
89	150	182997-1	GASKET,ADHESIVE,FOAM,1/8IN THICK, 3/8" WIDE,EPDM
88	1	173262-2	LABEL,PRODUCT IDENTIFICATION, TESTEVALDEV (TED)
87	1	176802-1	CABLE ASSY,JUMPER,BRAKE,DC POWER,YRC1000
86	2	703039-6	FUSE,ELECTRONIC,3AMP,250V,FAST ACTING,5X20mm
85	6	174327-2	FUSE,0.315A,125V,TIME DELAY,RADIAL LEADS
84	4	199279-1	SCREW,PAN HEAD,M2.5 X 8MM,SELF-TAPPING,ZINC PLATED,T8-HEAD
83	6	158366-1	SPACER,NYLON,ROUND,INSULATING
82	1	199005-1	RELAY,MULTI-FUNCTION/TIME DELAY,SPDT NO/NC,12-240VAC/DC COIL,8A CONTACTS
81	1	195293-1	CONNECTOR ASSY,OVERTRAVEL,JUMPER,CN204,YRC1000
80	1	199050-1	CABLE ASSY,DC-POWER,CN101 TO DC-POWER SUPPLY,SES/TED,
79	1	172891-1	DRIVE,USB,FLASH,16GB,USB 2.0,0-70C,READ 32MB/S,WRITE 10MB/S
78	1	199112-1	CABLE,USB-A TO USB-A (MALE/FEMALE) PANEL MOUNT,340MM LONG
77	6	199003-1	TERMINAL,INSULATED,PIGGYBACK,1/4INCH TERMINAL,14-16AWG
76	2500	199000-2	WIRE,18AWG,BLACK,600V 105DEG,THIN INSULATION,UL11028,CSA,CE
75	2200	185981-4	WIRE,16AWG,WHITE/BLUE,600V 105DEG,THIN INSULATION,UL11028,CSA,CE
74	2200	185359-4	WIRE,16AWG,BLUE,600V 105 DEG C,THIN INSULATION,UL11028,CSA,CE
73	2500	184073-1	WIRE,18AWG,WHITE,600V 105 DEG C,THIN INSULATION,UL11028,CSA,CE
72	1000	183777-4	WIRE,16AWG,GREEN/YELLOW,600V 105 DEG C,THIN INSULATION,UL11028,CSA,CE
71	1	193500-1	CARD,SD,512MB,SLC,W/O SOFTWARE,FOR ACP01 BOARD,YRC1000
70	1	199049-1	BOARD KIT,YRC1000,SES/TED KNOCK-DOWN KIT,

ITEM	QTY	P/N	DESCRIPTION
69	500	146335-3	DUCT COVER, 1.5"
68	500	146336-21	DUCT,WIRING,1.5X1,WHITE,
67	2	194000-1	BLOCK,TERMINAL,DISTRIBUTION,6-PORT/SINGLE POLE,24A,12-24AWG, CAGE CLAMP,DIN-RAIL MOUNT
66	2	703093-3	FUSE,ELECTRONIC,1AMP,250V,FAST ACTING,5X20mm
65	3	703039-1	FUSE,ELECTRONIC,2AMP,250V,FAST ACTING,5X20mm
64	1	195165-1	FUSE HOLDER ASSEMBLY,FU1 TO FU4,5MM X 20MM FUSES,
63	1	198317-1	POWER SUPPLY,90-260VAC INPUT,DUAL OUTPUT,12VDC & 24VDC,300W TOTAL,METAL CASE & FAN
62	2	405548-1	LABEL, FRAME GROUND
61	4	472361-2	NUT, LOCK, M4
60	6	130527-3	WASHER,LOCK,IET,#8,ZP
59	600	146147-3	WIRE,18AWG,GRN/YLW,UL1015/1230,600V,105C
58	6	143152-4	TERMINAL,RING,22-16AWG,#8/M4,
57	2	143047-7	PLATE,GLAND,XRC/MRC,BLANK
54	6000	185981-2	WIRE,20AWG,WHITE/BLUE,600V 105DEG,THIN INSULATION,UL11028,CSA,CE
53	1	196002-2	FAN,CROSSFLOW/TANGENTIAL,160MM,65CFM,24VDC,VARIABLE SPEED
52	2	187168-1	CONNECTOR,PROGRAMMING PORT,RJ45 BAYONET FRONT-SIDE, RIGHT-ANGLE RJ45 REAR-SIDE
51	2	187190-1	CAP DUST COVER,PLASTIC,PROGRAMMING PORT,BAYONET,M3 RETENTION STRAP
50	4	130422-3	SCREW,BHSC,M3X8
49	2	157947-3	CABLE,ETHERNET,8-WIRE,1.0M,RJ45-RJ45,SHIELDED (1 END)
47	200	146290-1	GROMMET,SERRATED STRIP, 0.052 OPENING, .125 IN WIDE
46	2	197455-1	BLOCK,POWER DISTRIBUTION,2-POLE,RED & BLACK,2-LINES/POLE, 48-LOADS/POLE,CAGE CLAMP
45	2	151267-1	CLAMP,END,DIN RAIL,TYPE CLIPFIX 35
44	305	146232-1	RAIL,DIN,35MM
43	200	146336-16	DUCT,WIRING,3/4X3/4,WHITE,
42	200	146335-1	DUCT, COVER,3/4 IN ,WHITE
41	1	185359-3	WIRE,24AWG,BLUE,600V 105 DEG C,THIN INSULATION,UL11028,CSA,CE
40	1	196748-1	CABLE ASSY,FUNCTIONAL SAFTEY IO,YRC1000,ASF01-CN206 TO X18-CN220
39	57	137146-2	SCREW,PPH,M4X8,JIS B 1188,W/CAPTIVE LOCK & FLAT WASHER
37	1	196748-2	CABLE ASSY,FUNCTIONAL SAFTEY IO,YRC1000,ASF02-CN222 TO X181-CN220
36	1	183372-1	BOARD ASSY,PC,SAFETY RELAY BREAKOUT BOARD,
35	1	197831-1	SENSOR,THERMOCOUPLE,J-TYPE,12INCH LEADS,MOUNTING SCREW ATTACHMENT
34	6000	185359-2	WIRE,20AWG,BLUE,600V 105 DEG C,THIN INSULATION,UL11028,CSA,CE
33	1	197829-1	CONTROLLER,TEMPERATURE/PROCESS CONTROLLER,PID,1/16DIN, 100-230VAC PWR,ANALOG OUTPUT
32	1	155538-6	SWITCH,ETHERNET, 8 RJ45,10/100,DIN MNT,24VDC,MANAGED, PRE-LOADED YAI CONFIGURATION Rev:1.0.1
31	4	130443-12	WASHER, FLAT, #6 SAE
30	4	130444-2	WASHER, LOCK, #6
29	4	130209-1	SCREW,PPH,#6-32X3/8,
20	2	186393-3	HANDLE,ROUND GRIP SPRING-LOADED CHEST LIFTING,FOUR 0.2INCH MOUNTING HOLES,NICKLE PLATED
18	3	157055-1	TERMINAL,QUICK DISC,RECEPTACLE
17	1	195999-1	SWITCH,ROCKER,SPST-NO,10A,125VAC,RED ILLUMINATION, PANEL-MOUNT,QUICK-DISCONNECT TERMINALS
16	1	158334-5	CABLE ASSY, PUSH BUTTON RESET, PANEL MOUNT, NC CONTACT, 750MM
15	1	196659-2	LABEL KIT,INTERFACE,SIMPLIFIED TRAINING SYSTEM,YRC1000,
14	1	171777-1	CABLE ASSY,DX200,YCP21-VGA,FEMALE,VGA
13	2	196000-2	OUTLET,125VAC,15A,PANEL MOUNT/SNAP-IN,UL/cUL,CSA,SOLDER TERMINALS
12	1	154761-2	CORD,POWER,MOLDED,120VAC,MALE/FLYING LEADS,16AWG,13A
11	1	131380-16	GRIP, CORD, PLASTIC, .197-.394
10	8	196001-1	FOOT,RUBBER,M6X6MM THREADED STUD,19MM FOOT OD
9	1	183362-1	ACCESSORY KIT,DIRECT CONNECT IO BREAKOUT CARD KIT,
8	4	158900-1	NUT, HEX FLANGE, M4x0.7
4	3	157947-2	CABLE,ETHERNET,8-WIRE,0.5M,RJ45-RJ45,SHIELDED (1 END)
2	1	196916-2	DIAGRAM,TESTEVALDEV,ENCLOSURE,W/SAFETY IO + ETHERNET SWITCH
1	1	195554-2	ENCLOSURE,TESTEVALDEV(TED),WELDMENT ASSY,

REV	DATE	ECN / DESCRIPTION	CHG BY/APV BY
3	11/1/24	ECN-01077	JRB JAY
2	4/25/24	ECN-00478	JRB JAY
1	2/26/24	ECN-00254	JRB JAY

PROJECTION
METRIC
DO NOT SCALE DRAWING

UNLESS OTHERWISE SPECIFIED, DIMENSIONS ARE IN SI UNITS. TOLERANCES TO THE LEFT APPLY EXCEPT FOR VENDOR DESIGNED PARTS AND ITEMS PRODUCED TO RECOGNIZED STANDARDS. DIMENSIONS AND TOLERANCES PER ASME Y14.5M-2009.

FILE NAME: 196760-2.dft

DESIGNED JAY	DRAWN JRB 1/30/2024	CHECKED BJG 2/26/2024
APPROVAL 1 JAY 3/1/2024	APPROVAL 2	RELEASE TNF 3/1/2024
MATERIAL	SCALE (UNLESS OTHERWISE NOTED) 1:2	
FINISH	DWG SIZE A1	MASS 14.3 kg
	DEPT. PSG	

MOTOMAN ROBOTICS DIVISION
MIAMISBURG, OHIO 45342 USA (937) 847-6200

TITLE
CABINET ASSY,TESTEVALDEV (TED),WITH FSU SAFETY IO AND MANAGED ETHERNET SWITCH

DRAWING NO. 196760-2

SHEET 1 OF 4

11/11/2024 1:46:52 PM

CONFIDENTIAL: THIS DRAWING CONTAINS A PROPRIETARY DESIGN ORIGINATED BY YASKAWA AMERICA INC. (MOTOMAN ROBOTICS DIVISION (YASKAWA MOTOMAN)). NEITHER IT NOR THE INFORMATION APPEARING HEREON SHALL BE DISCLOSED, USED, OR DUPLICATED FOR ANY PURPOSE UNLESS SPECIFICALLY AUTHORIZED BY MOTOMAN ROBOTICS. THIS DRAWING IS THE PROPERTY OF MOTOMAN ROBOTICS AND SHALL BE RETURNED TO IT UPON REQUEST. ALL PATENT RIGHTS RELATING HERETO ARE SPECIFICALLY RESERVED.

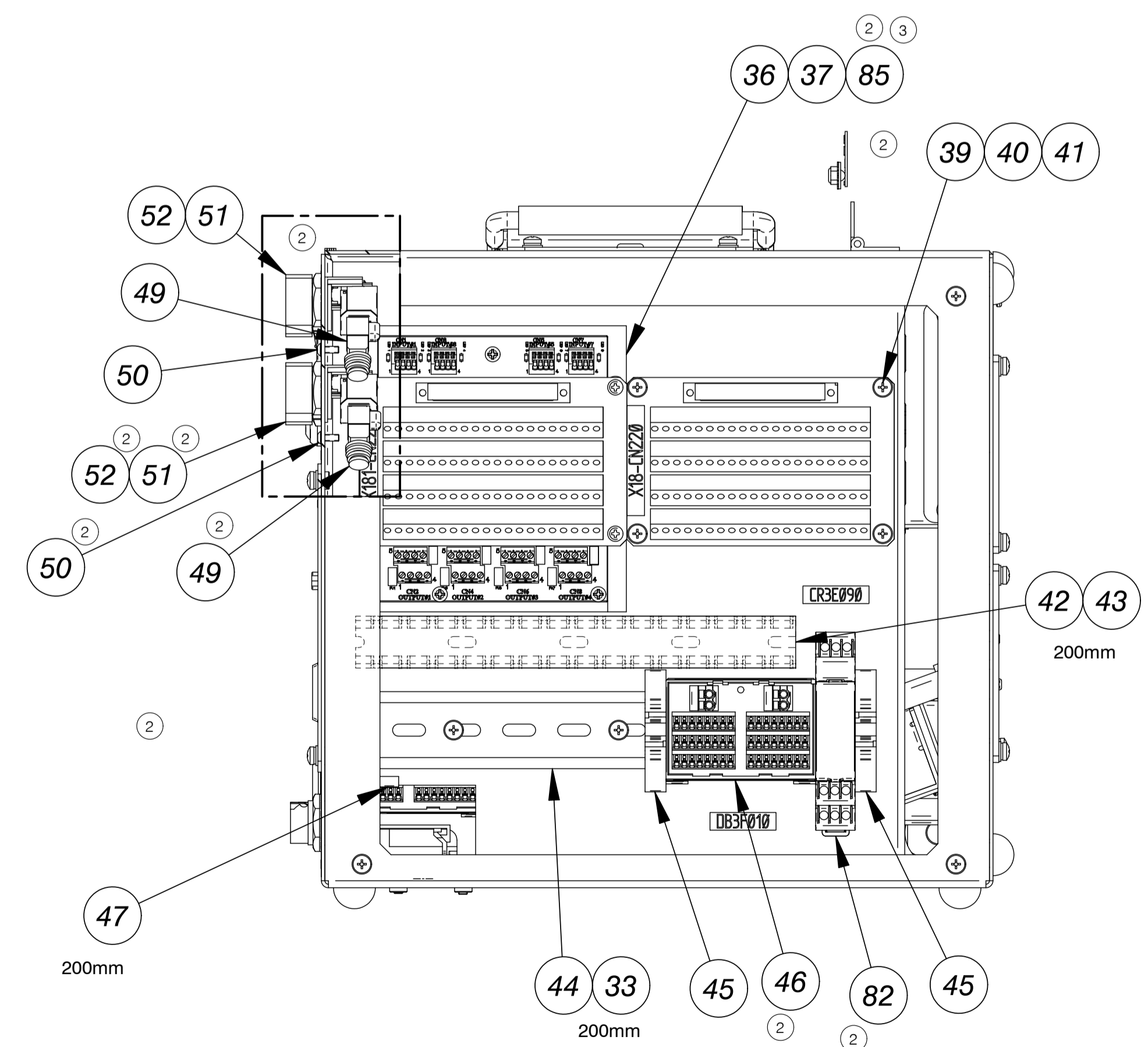
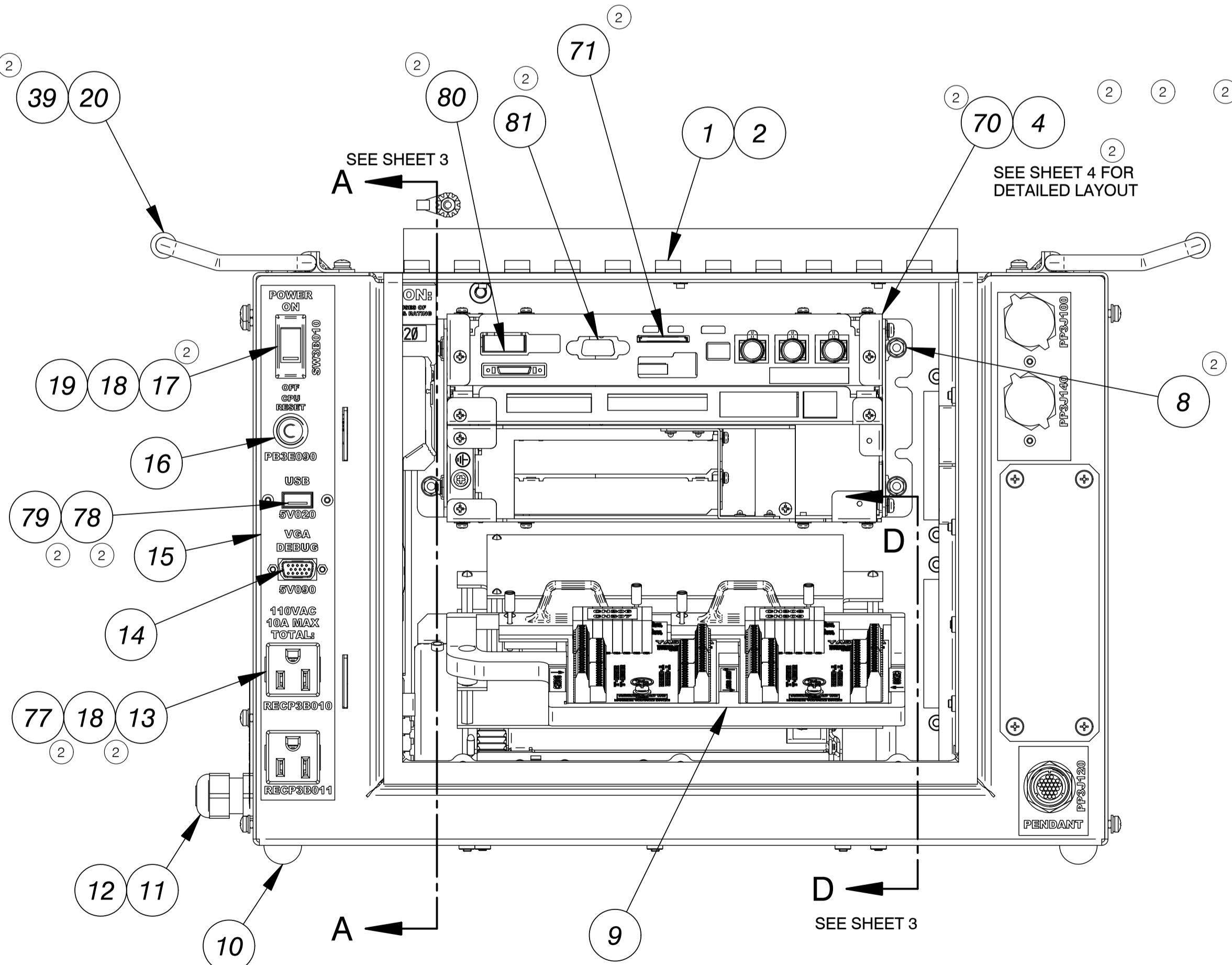
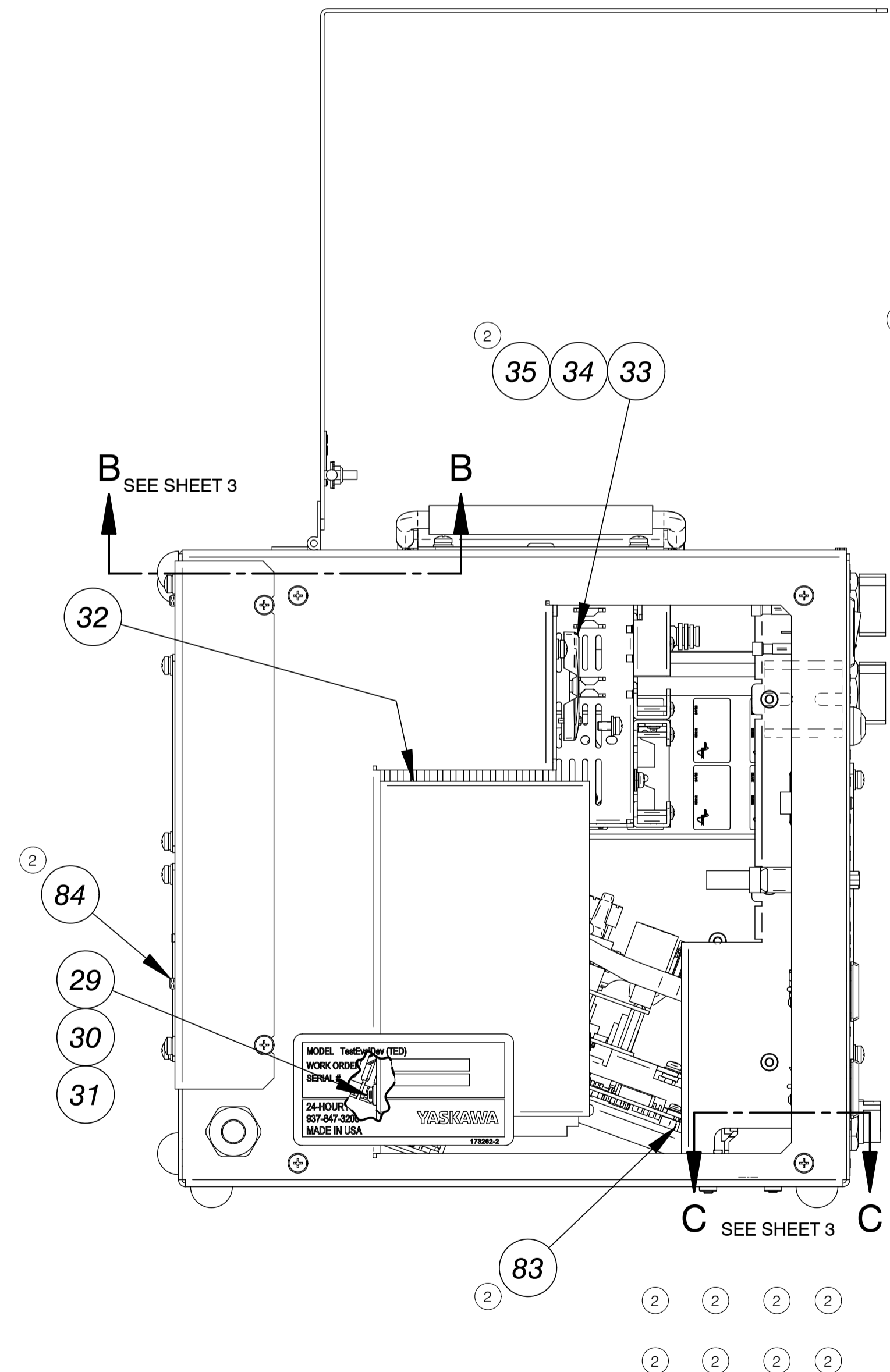
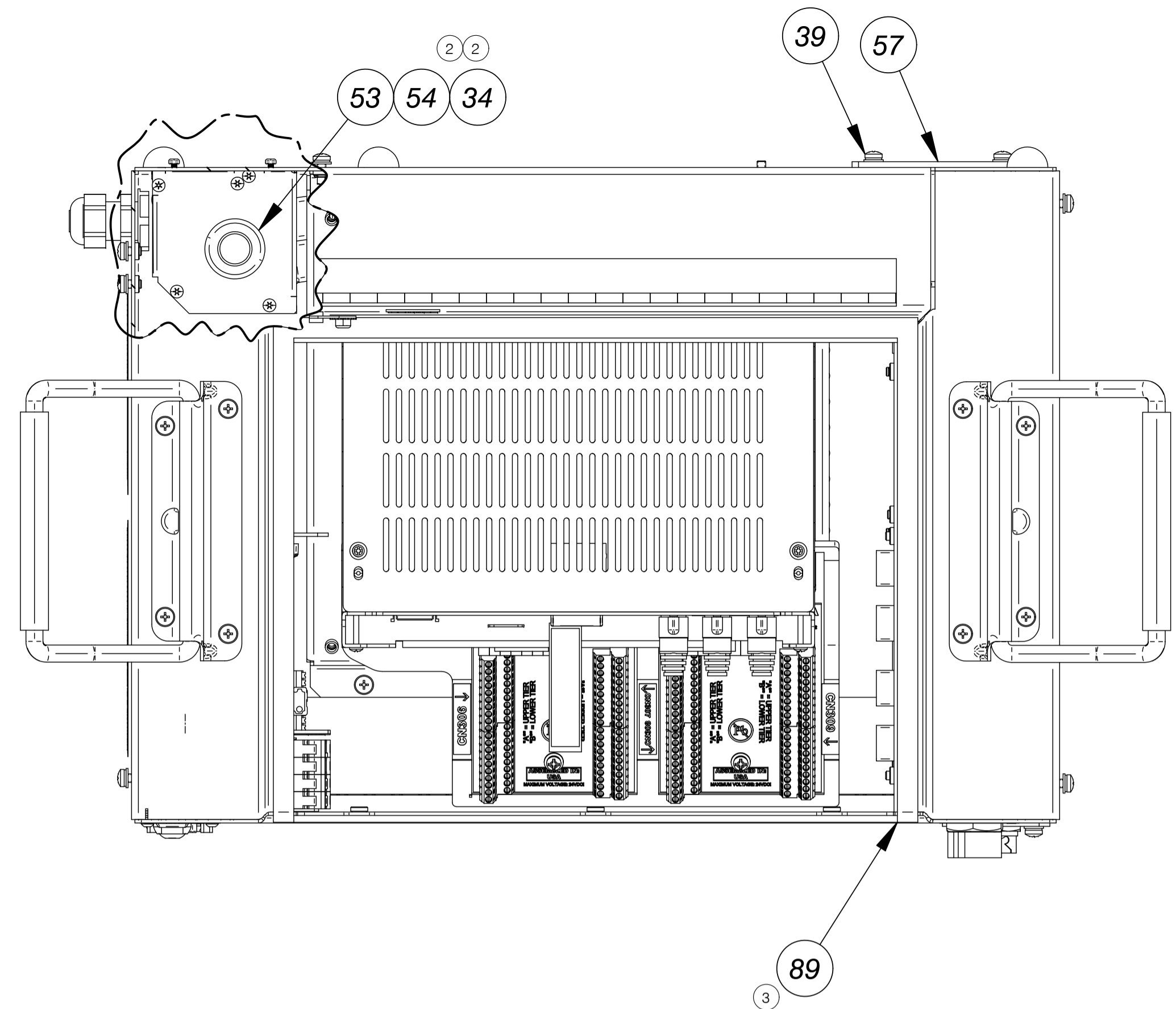

REV	DATE	ECN / DESCRIPTION	CHG BY	APV BY
3	11/1/24	ECN-01077	JRB	JAY
2	4/25/24	ECN-00478	JRB	JAY
1	2/26/24	ECN-00254	JRB	JAY

PROJECTION	
DECIMAL	0. ± 1. 0.0 ± 0.4 0.00 ± 0.12 0.000 ± 0.012 ANGLES ± 30'
FILE NAME	196760-2.dft

DESIGNED	JAY
APPROVAL 1	JAY 3/1/2024
MATERIAL	
FINISH	

DRAWN	JRB 1/30/2024
APPROVAL 2	
FILE NAME	196760-2.dft

CHECKED	BJG 2/26/2024
RELEASE	TNF 3/1/2024
SCALE (UNLESS OTHERWISE NOTED)	1:2
DWG SIZE	A1
MASS	14.3 kg
DEPT.	PSG

MOTOMAN ROBOTICS DIVISION
 MIAMISBURG, OHIO 45342 USA (937) 847-6200

TITLE	CABINET ASSY, TESTEVALDEV (TED), WITH FSU SAFETY IO AND MANAGED ETHERNET SWITCH
DRAWING NO.	196760-2
SHEET 2 OF 4	

11/11/2024 1:46:52 PM

CONFIDENTIAL: THIS DRAWING CONTAINS A PROPRIETARY DESIGN ORIGINATED BY YASKAWA AMERICA INC. (MOTOMAN ROBOTICS DIVISION (YASKAWA MOTOMAN)), NEITHER IT NOR THE INFORMATION APPEARING HEREON SHALL BE DISCLOSED, USED, OR REPRODUCED FOR ANY PURPOSE UNLESS SPECIFICALLY AUTHORIZED BY MOTOMAN ROBOTICS. THIS DRAWING IS THE PROPERTY OF MOTOMAN ROBOTICS AND SHALL BE RETURNED TO IT UPON REQUEST. ALL PATENT RIGHTS RELATING HERETO ARE SPECIFICALLY RESERVED.

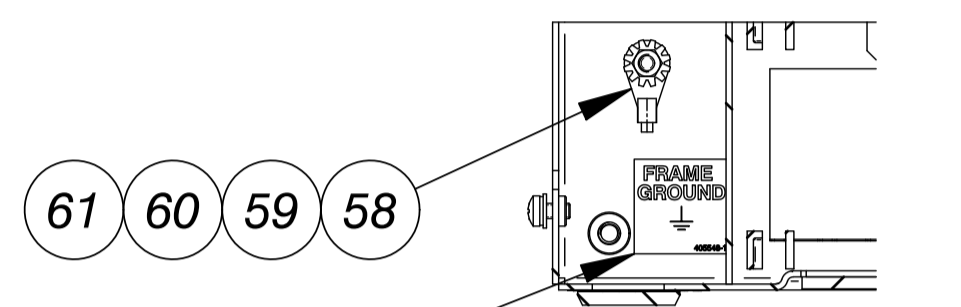

SECTION C-C
FROM SHEET 2
ROTATED 90° CCW

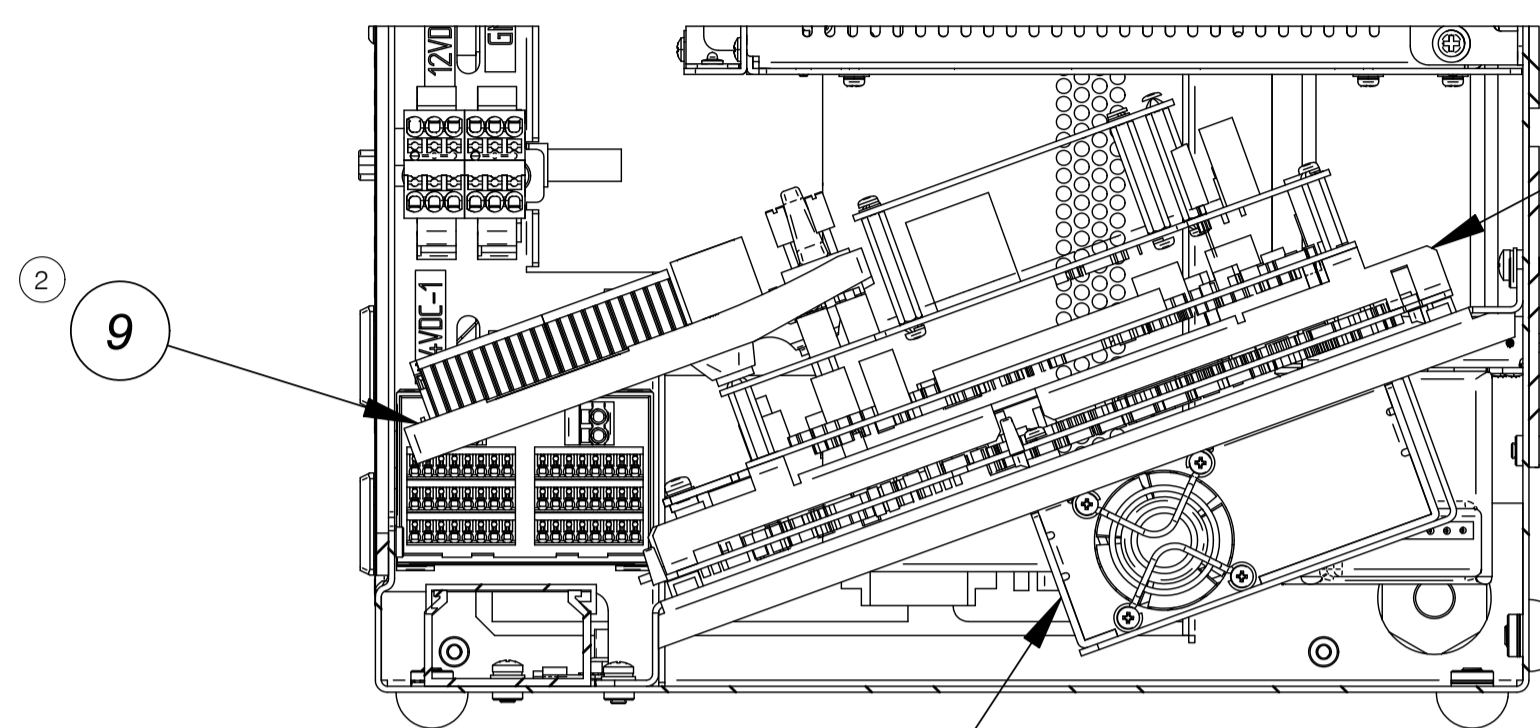

SECTION D-D
FROM SHEET 2

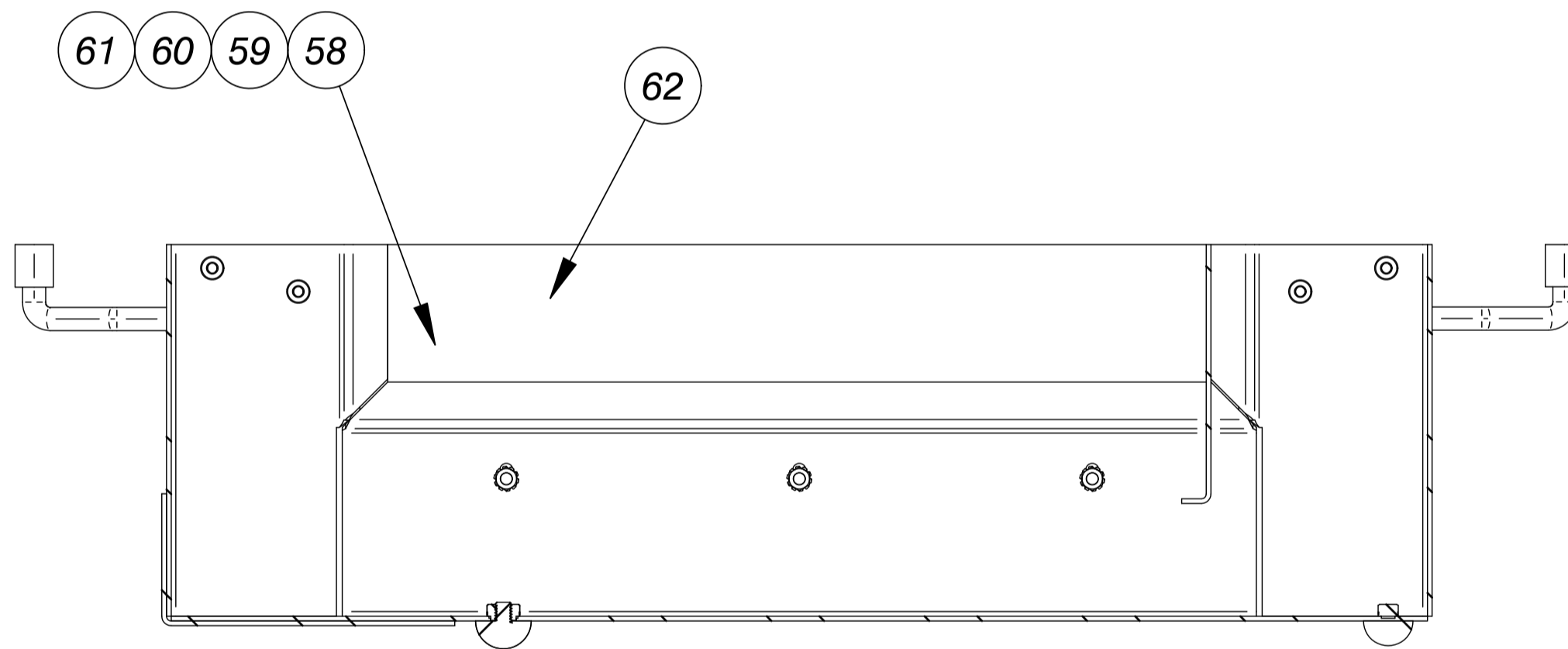

SECTION B-B
FROM SHEET 2
ROTATED 90° CCW

70
SEE SHEET 4 FOR
DETAILED LAYOUT

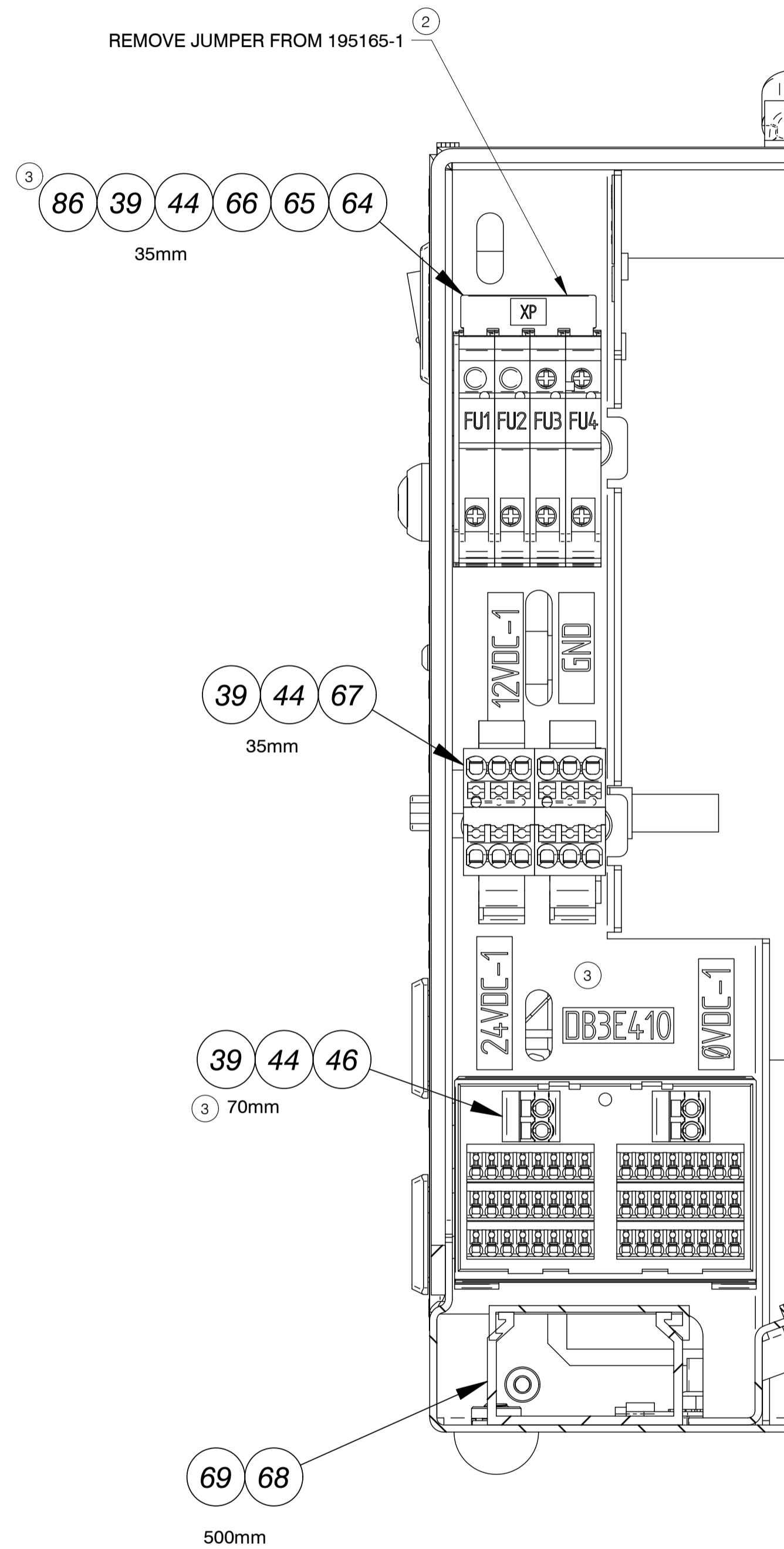

SECTION A-A
FROM SHEET 2
1:1

REV	DATE	ECN / DESCRIPTION	CHG BY	APV BY
3	11/1/24	ECN-01077	JRB	JAY
2	4/25/24	ECN-00478	JRB	JAY
1	2/26/24	ECN-00254	JRB	JAY

REVISION TABLE

PROJECTION	
DECIMAL	0. ± 1. 0.0 ± 0.4 0.00 ± 0.12 0.000 ± 0.012 ANGLES ± 30°

METRIC
DO NOT SCALE DRAWING

UNLESS OTHERWISE SPECIFIED, DIMENSIONS ARE IN SI UNITS. TOLERANCES TO THE LEFT APPLY EXCEPT FOR VENDOR DESIGNED PARTS AND ITEMS PRODUCED TO RECOGNIZED STANDARDS. DIMENSIONS AND TOLERANCES PER ASME Y14.5M-2009.

FILE NAME: 196760-2.dft

DESIGNED	JAY
DRAWN	JRB 1/30/2024
CHECKED	BJG 2/26/2024
APPROVAL 1	JAY 3/1/2024
APPROVAL 2	
MATERIAL	
FINISH	

DWG SIZE	MASS	DEPT.
A1	14.3 kg	PSG
SCALE (UNLESS OTHERWISE NOTED)		
1:2		

MOTOMAN ROBOTICS DIVISION
MIAMISBURG, OHIO 45342 USA (937) 847-6200

TITLE	CABINET ASSY, TESTEVALDEV (TED), WITH FSU SAFETY IO AND MANAGED ETHERNET SWITCH
DRAWING NO.	196760-2
SHEET 3 OF 4	

11/11/2024 1:46:52 PM

CONFIDENTIAL: THIS DRAWING CONTAINS A PROPRIETARY DESIGN ORIGINATED BY YASKAWA AMERICA INC. (MOTOMAN ROBOTICS DIVISION (YASKAWA MOTOMAN)), NEITHER IT NOR THE INFORMATION APPEARING HEREON SHALL BE DISCLOSED, USED, OR REPRODUCED FOR ANY PURPOSE UNLESS SPECIFICALLY AUTHORIZED BY MOTOMAN ROBOTICS. THIS DRAWING IS THE PROPERTY OF MOTOMAN ROBOTICS AND SHALL BE RETURNED TO IT UPON REQUEST. ALL PATENT RIGHTS RELATING HERETO ARE SPECIFICALLY RESERVED.

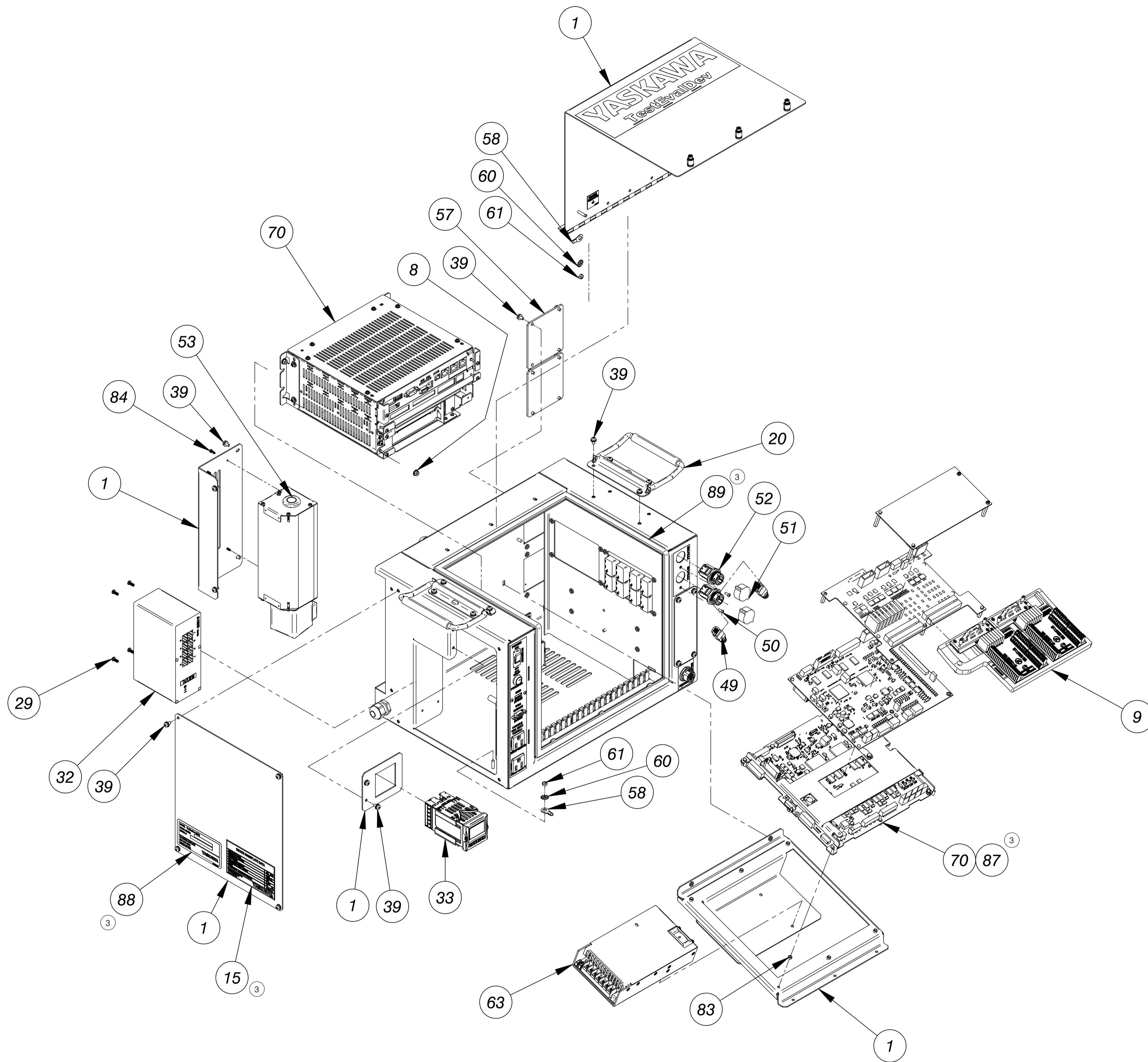

EXPLODED VIEW
1:4

REV	DATE	ECN / DESCRIPTION	CHG BY	APV BY
3	11/1/24	ECN-01077	JRB	JAY
2	4/25/24	ECN-00478	JRB	JAY
1	2/26/24	ECN-00254	JRB	JAY

REVISION TABLE

PROJECTION	
DECIMAL	0. ± 1. 0.0 ± 0.4 0.00 ± 0.12 0.000 ± 0.012 ANGLES ± 30°

METRIC
DO NOT SCALE DRAWING

UNLESS OTHERWISE SPECIFIED, DIMENSIONS ARE IN SI UNITS. TOLERANCES TO THE LEFT APPLY EXCEPT FOR VENDOR DESIGNED PARTS AND ITEMS PRODUCED TO RECOGNIZED STANDARDS. DIMENSIONS AND TOLERANCES PER ASME Y14.5M-2009.

FILE NAME: 196760-2.dft

DESIGNED: JAY
APPROVAL 1: JAY 3/1/2024
MATERIAL:
FINISH:

DRAWN: JRB 1/30/2024
APPROVAL 2:

CHECKED: BJB 2/26/2024
RELEASE: TNF 3/1/2024
SCALE (UNLESS OTHERWISE NOTED): 1:2

TITLE	CABINET ASSY,TESTEVALDEV (TED),WITH FSU SAFETY IO AND MANAGED ETHERNET SWITCH
DRAWING NO.	196760-2
SHEET 4 OF 4	(2)

11/11/2024 1:46:52 PM